

Ref. : DI 7251N

Rev. : D

Date : 25/03/2021

Page : 1/1

RUBBER EXPANSION JOINT WITH SWIVEL FLANGES PN25 AND CONTROL RODS DI 7251N



APPLICATION

Hot water, cold water, water treatment, sewerage, heating, air conditioning, control of vibrations and noise on pipes etc.

GENERAL CHARACTERISTICS

- From DN32 to DN300.
- Swivel flanges.
- Angular movement in accordance with DN.
- Galvanized steel flanges PN25.

CONSTRUCTION

8	Reinforcement	Nylon tyre
7	Reinforced wire	Steel
6	Rubber	EPDM
5	Flange	Zinc-plated steel
4	Control rod	Galvanized steel
3	Plate	Steel
2	Spring	Steel
1	Nut	Steel
Pos.	Description	Material

DIMENSIONS

DN		L	L1	ØK	n x ØH	ØD	T	T1	n1xM	Lc	Le	Li	A°	Weight (kg)
mm	inch													
32	1"1/4	240	95	100	4 x Ø18	140	10	18	2 x M16	10	6	10	5°	15.4
40	1"1/2	240	95	110	4 x Ø18	150	10	18	2 x M16	10	6	10	5°	15.9
50	2"	250	105	125	4 x Ø18	165	10	20	2 x M16	10	6	10	5°	18
65	2"1/2	260	115	145	8 x Ø18	185	10	22	2 x M16	12	8	15	5°	19.7
80	3"	280	135	160	8 x Ø18	200	10	24	2 x M16	12	8	15	5°	21
100	4"	290	135	190	8 x Ø23	235	10	24	2 x M16	16	12	20	5°	24.4
125	5"	325	165	220	8 x Ø27	270	10	26	2 x M16	16	12	20	5°	30.6
150	6"	340	180	250	8 x Ø27	300	12	28	2 x M16	16	12	20	5°	34.1
200	8"	400	205	310	12 x Ø27	360	16	30	3 x M20	16	12	20	3°	53.9
250	10"	470	240	370	12 x Ø30	425	25	32	3 x M24	25	14	30	3°	81.8
300	12"	490	260	430	16 x Ø30	485	25	34	3 x M24	25	14	30	1°	107

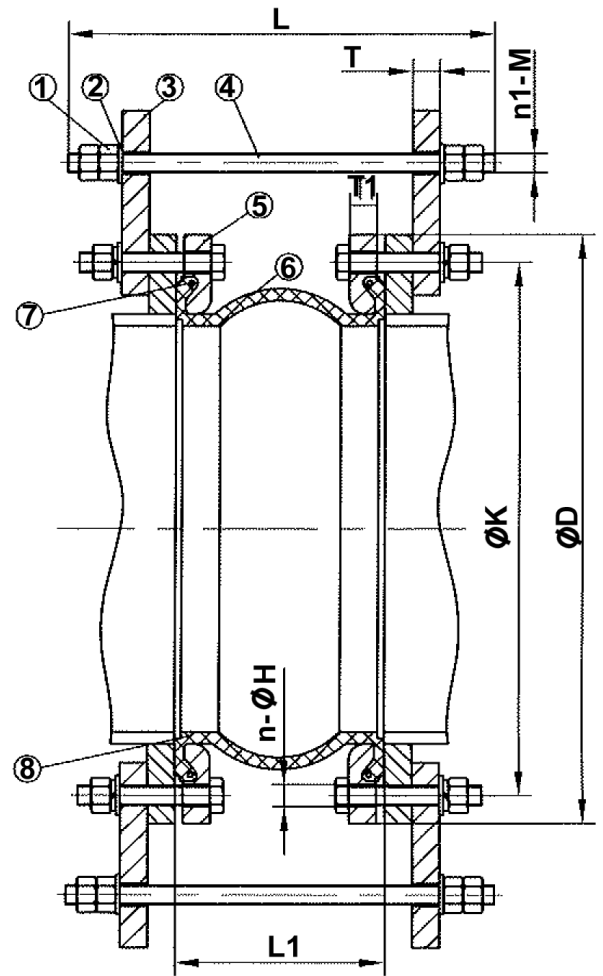

WORKING CONDITIONS

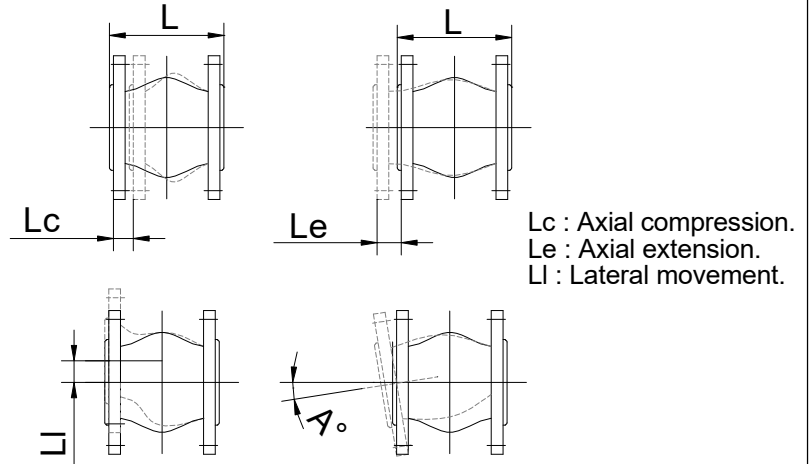
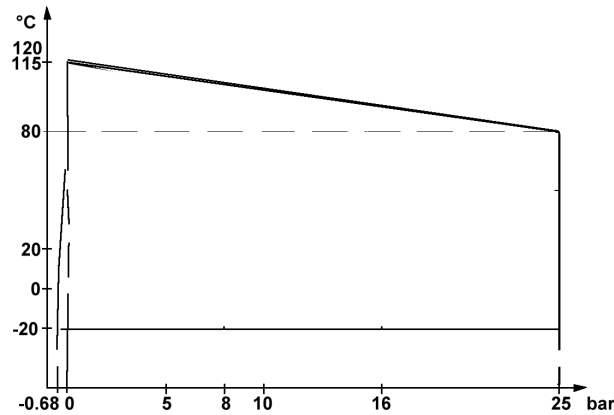

STANDARDS

Test procedures are established according to standards EN 12266-1, DIN 3230, BS 6755 and ISO 5208. Flanges drilled according to standard EN 1092-1 : ISO PN25.

TECOFI France - 83, Rue Marcel Mérieux 69960 Corbas - FRANCE
Tél. +33 (0) 4 72 79 05 79 - Fax +33 (0) 4 78 90 19 19 / +33 (0) 4 72 79 05 70
Adresses e-mail : sales@tecofi.fr ; tecofi@tecofi.fr / Site web : www.tecofi.fr