

Ref. : DI 724116N

Rev. : E

Date : 30/01/2017

Page : 1/1

RUBBER EXPANSION JOINT WITH SWIVEL FLANGES PN16 AND CONTROL RODS DI 724116N



APPLICATION

Hot water, cold water, water treatment, sewerage, heating, air conditioning, control of vibrations and noise on pipes etc.

GENERAL CHARACTERISTICS

- From DN 350 to DN 600.
- Swivel flanges.
- Angular movement 8°.
- Galvanized steel flanges PN16.

CONSTRUCTION

8	Reinforcement	Nylon tyre
7	Reinforced wire	Steel
6	Rubber	EPDM
5	Flange	Zinc-plated steel
4	Control rod	Galvanized steel
3	Plate	Steel
2	Spring	Steel
1	Nut	Steel
Pos.	Description	Material

DIMENSIONS

DN		L	L1	ØC	n x ØH	ØD	T	T1	n1xM	Lc	Le	Li	A°	Weight (kg)
mm	inch													
350	14"	490	265	470	16 x Ø27	520	30	25	4 x M30	30	14	25	8°	54.56
400	16"	510	265	525	16 x Ø30	580	30	27	4 x M30	30	14	25	8°	67.20
450	18"	530	265	585	20 x Ø30	640	30	29	5 x M30	30	14	25	8°	82.00
500	20"	530	265	650	20 x Ø34	715	30	29	5 x M33	30	14	25	8°	106.00
600	24"	550	265	770	20 x Ø36	840	30	29	5 x M33	30	14	25	8°	129.00

WORKING CONDITIONS

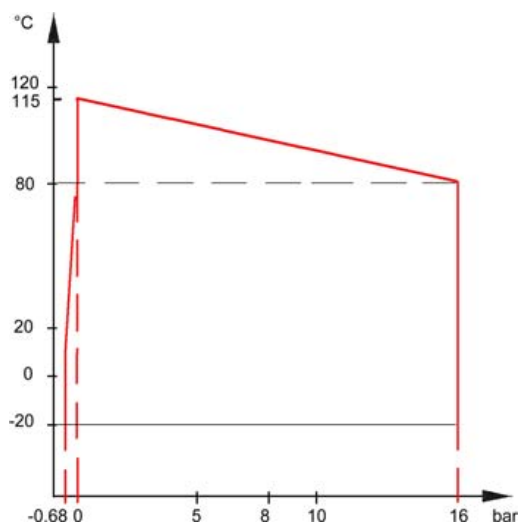

STANDARDS

Test procedures are established according to standards EN 12266-1, DIN 3230, BS 6755 and ISO 5208. Flanges drilled according to standard EN 1092-1 : ISO PN16.

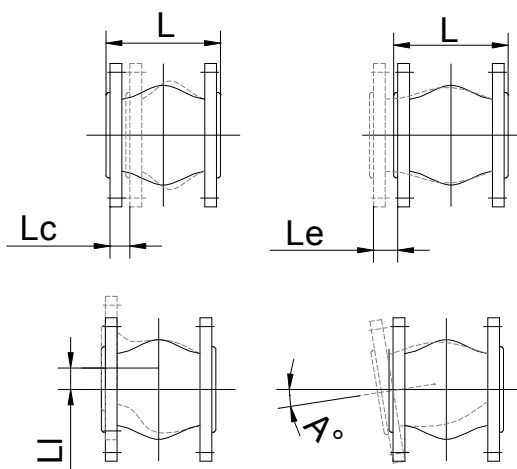
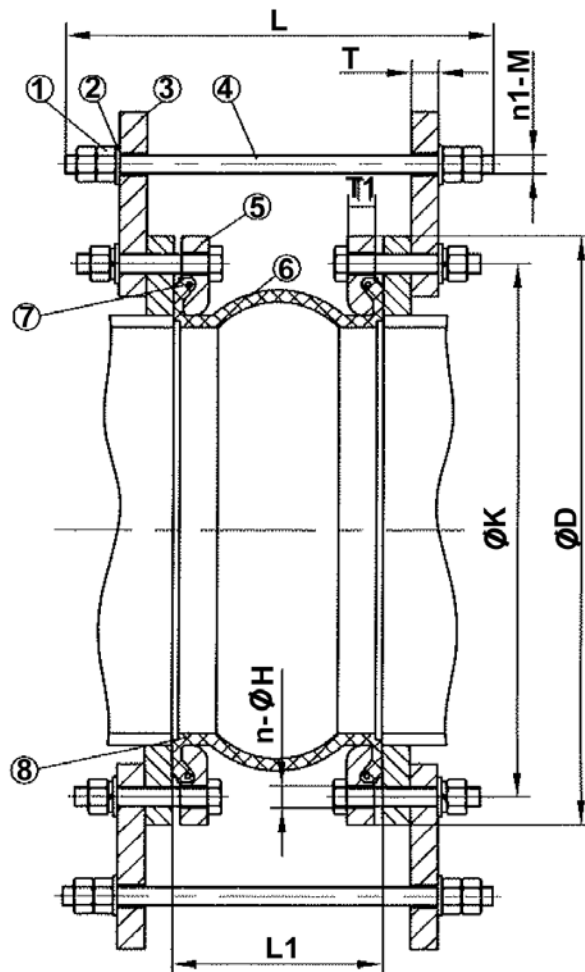

Lc : Axial compression.
Le : Axial extension.
Li : Lateral movement.