

# FLANGED AXIAL CHECK VALVE

TECHNICAL PASSPORT

## FLANGED PN10 AXIAL CHECK VALVE CAST IRON BODY

CA 3201

### APPLICATION

Non-return check valve.

**Area of use:** Industries, fluid pumping, water supply, hydraulic networks, etc.



**Fluids:** clear water, uncharged liquids, non-corrosive products, etc



### GENERAL CHARACTERISTICS

**Range:** from DN50 to DN300.

- Non -return valve in cast iron all positions.
- Simple axial guidance prevents blocking of the disc.
- Mounting direction is indicated on the body by an arrow.
- Low cracking pressure.
- Low head losses
- Simple installation and use.
- Stainless steel return spring for mounting in any position.
- Sealing ensured by flat nitrile gasket.

### STANDARDS

<b>Design</b>	Design according to EN 12334, ASME B16.1, ASME B16.42.
<b>Connection</b>	Flanges drilled according to EN 1092-2 and DIN 2501/1 : ISO PN10.
<b>Tests</b>	Pressure test according to standards EN12266-1, DIN 3230, BS 5154 and ISO 5208: Body : 15 bar Seat : 11 bar

### PRODUCT APPROVALS

**ERC**

**Tecofi France**

83 rue Marcel Mérieux - 69960 Corbas  
Tél. +33 (0)4 72 79 05 79 - Fax. +33 (0)4 78 90 19 19  
E-mail : sales@tecofi.fr - [www.tecofi.fr](http://www.tecofi.fr)



## FLANGED AXIAL CHECK VALVE

### TECHNICAL PASSPORT

CA 3201

#### CONSTRUCTION

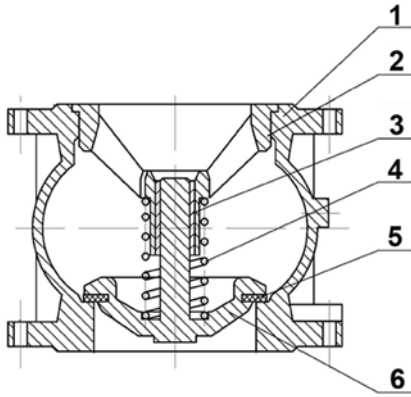

Component	Coating
Body	Epoxy powder RAL 5017 thickness 150µm

Pos.	Description	Material
1	Body	Cast iron EN-GJL-250
2	Guide	Ductile iron EN-GJS-400-15
3	Closing system	Brass
4	Spring	Stainless steel 316
5	Gasket	NBR
6	Disc	Ductile iron EN-GJS-400-15

#### DIMENSIONS

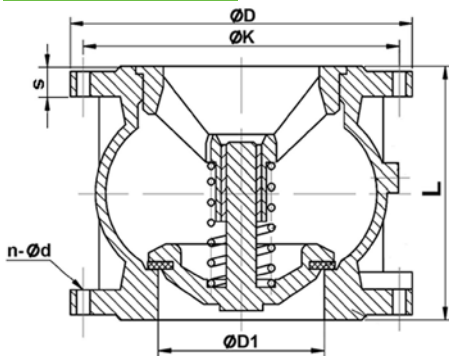

DN		L	ØD1	ØD	Ø K	S	n x Ød	Weight (kg)
mm	inch							
50	2"	100	50	165	125	17	4 x 19	5,09
65	2 1/2"	120	65	185	145	17	4 x 19	7.85
80	3"	140	80	200	160	19	8 x 19	9.53
100	4"	170	101	220	180	21	8 x 19	13,2
125	5"	200	127	250	210	23	8 x 19	20.5
150	6"	230	145	285	240	23	8 x 23	29.6
200	8"	300	194	340	295	27	8 x 23	47.3
250	10"	370	245	395	350	29	12 x 23	68
300	12"	410	300	445	400	29	12 x 23	112

#### WORKING CONDITIONS

Maximum working pressure : 10 bar  
Maximum working temperature : 0°C / +80°C

#### HEAD LOSS DIAGRAMM

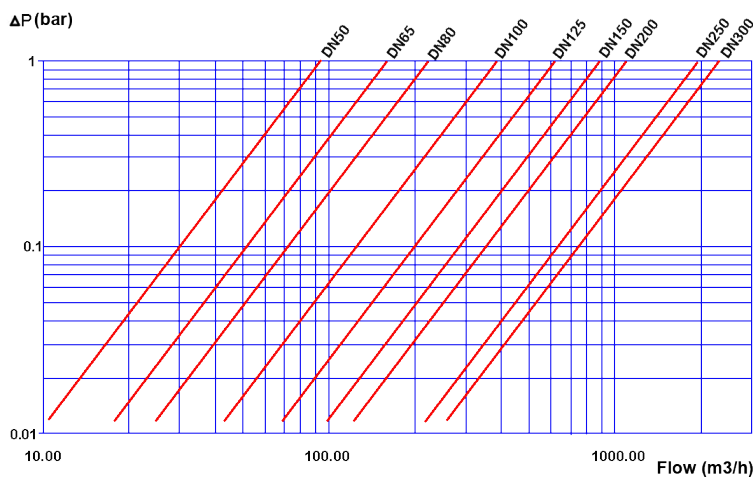

**Tecofi France**

83 rue Marcel Mérieux - 69960 Corbas  
Tél. +33 (0)4 72 79 05 79 - Fax. +33 (0)4 78 90 19 19  
E-mail : sales@tecofi.fr - [www.tecofi.fr](http://www.tecofi.fr)

