

## BALL VALVE

### TECHNICAL PASSPORT

#### THREADED BALL VALVE FULL BORE

BSM6179-02

#### APPLICATION

**Area of use:** Chemical industries, petrochemical industries, hydraulic installation, heating and water distribution



**Fluids:** water, oil, compatible liquid products.



#### GENERAL CHARACTERISTICS

**Range:** DN 1/4" to DN 4".

- Full bore, anti blow-out stem.
- Gland packing for stem tightness
- Double seal PTFE / FKM on the shaft
- Handle with lockable device
- With top flange according to ISO5211

#### CONSTRUCTION

Pos.	Quantity	Description	Material
1	1	Body	Stainless steel CF8M
2	2	Ball seat	R-PTFE (15%)
3	1	Ball	Stainless steel 316
4	1	Body gasket	PTFE
5	1	Cap	Stainless steel CF8M
6	1	Stem	Stainless steel 316
7	1	Thrust washer	PTFE
8	1	O-Ring	Viton
9	1	Stem packing	PTFE
10	1	Packing ring	Stainless steel 304
11	2	Belleville washer	Stainless steel 304
12	1	Nut stopper	Stainless steel 304
13	2	Nut	Stainless steel 304
14	2	Plate washer	Stainless steel 304
15	1	Lock device	Stainless steel 304
16	1	Handle	Stainless steel 304
17	1	Cover	Plastic
18	1	Stop pin	Stainless steel 304

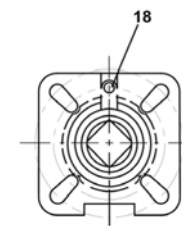
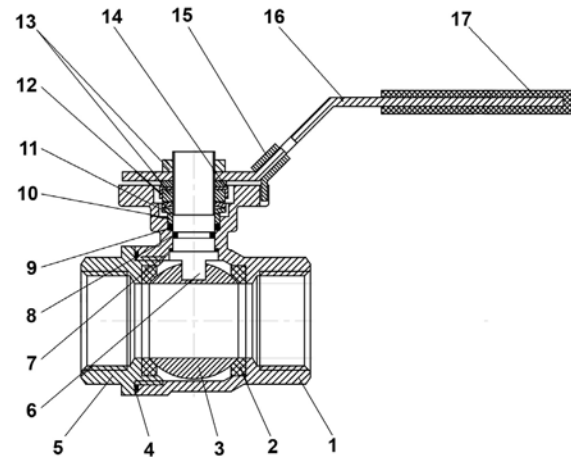

ISO5211

#### STANDARDS

<b>Design</b>	According to EN12516-1/-2, EN12266-1
<b>Connection</b>	BSP female threaded according to ISO 7/1 Rp.
<b>Tests</b>	Pressure test according to standards EN12266-1, API598. - Body : PS x 1.5 (bar) - Seat : PS x 1.1 (bar)

#### PRODUCT APPROVALS



**Tecofi France**

83 rue Marcel Mérieux - 69960 Corbas  
Tél. +33 (0)4 72 79 05 79 - Fax. +33 (0)4 78 90 19 19  
E-mail : sales@tecofi.fr - [www.tecofi.fr](http://www.tecofi.fr)



## BALL VALVE

### TECHNICAL PASSPORT

#### THREADED BALL VALVE FULL BORE

**BSM6179-02**

#### DIMENSIONS

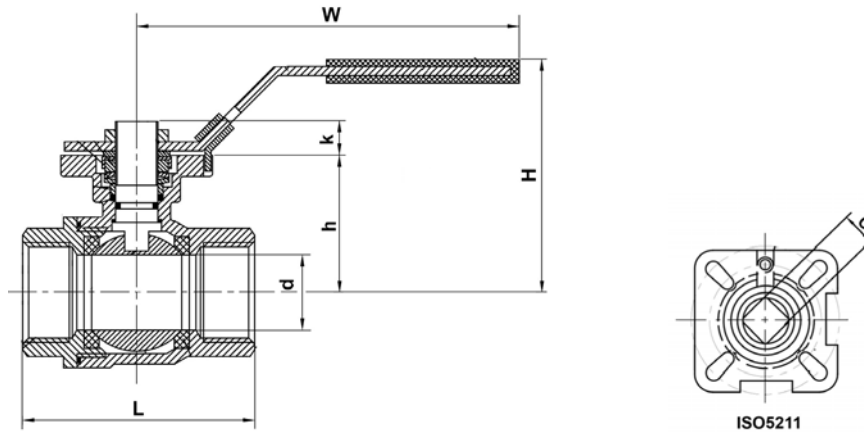

DN		d	L	H	h	k	W	C	ISO5211	Torque* (Nm)	Weight (kg)
inch	mm										
1/4"	8	11.5	56	65	37	8.7	115	9	F03	5	0.37
3/8"	10	12.5	56	65	37	8.7	115	9	F03	5	0.35
1/2"	15	15	57	65	37	8.7	117	9	F03/F04	5	0.37
3/4"	20	20	64	70	42.2	8.8	117	9	F03/F04	8	0.49
1"	25	25	77	75	45.5	10.7	134	11	F04/F05	10	0.74
1 1/4"	32	32	90	85	54	10.5	134	11	F04/F05	14	1.18
1 1/2"	40	40	105	95	59.5	14	203	14	F05/F07	18	1.94
2"	50	50	125	105	67.5	13.5	203	14	F05/F07	25	2.90
2 1/2"	65	65	153	140	93	18.5	255	17	F07/F10	48	5.77
3"	80	76	172	145	109	17.5	255	17	F07/F10	75	8.45
4"	100	94	221	175	121	20.5	302	17	F07/F10	110	15.60

\* - Torque value without safety factor.

#### WORKING CONDITIONS

Maximum working pressure : 69 bar from DN 1/4" to DN 1 1/2"  
63 bar from DN 2" to DN 4"

Maximum working temperature: -25°C /+180°C.

#### PRESSURE-TEMPERATURE RATING

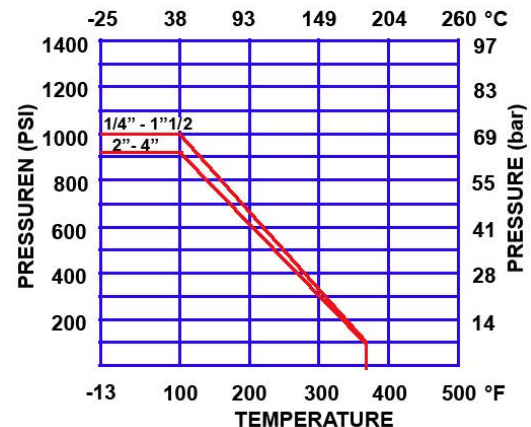

**Tecofi France**

83 rue Marcel Mérieux - 69960 Corbas  
Tél. +33 (0)4 72 79 05 79 - Fax. +33 (0)4 78 90 19 19  
E-mail : sales@tecofi.fr - [www.tecofi.fr](http://www.tecofi.fr)



The photographs and technical art works are not contractual. The specifications of the presented products are open to modifications without previous advice