

Ref. : BS 1141.pas

Rev. : A

Date : 22/03/2010

Page : 1/1

# FULL BORE BALL VALVE WITH BUTTERFLY HANDLE

## BS 1141



### APPLICATION

General use : hot water, cold water, drinking water.

### GENERAL CHARACTERISTICS

From DN 1/4" to DN 1".  
 Full bore.  
 Solid ball  
 Unjectable stem.  
 Sealing of the axis by packing gland.  
 Butterfly handle.  
 Female threaded ends.

### CONSTRUCTION

11	Screw	Steel
10	Handle	Aluminium alloy
9	Gasket	PTFE
8	O-Ring	EPDM
7	Ends	Brass
6	Packing	PTFE
5	Packing gland	Brass
4	Seat	PTFE
3	Stem	Brass
2	Ball	Brass
1	Body	Brass MS58
Pos.	Description	Material

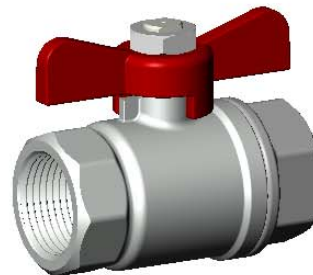

### DIMENSIONS

DN		L	L1	L2	H	Weight (kg)
mm	inch					
8	1/4"	39	8	46	32	0,12
12	3/8"	40	8,5	54	33	0,19
15	1/2"	49	10	54	37	0,15
20	3/4"	54	11	54	41	0,23
25	1"	64	13	70	49	0,44

### WORKING CONDITIONS

Temperature mini : - 20 °C  
 Temperature max : + 120 °C

Pressure max 25 bar up to 95°C, 16 bar beyond.

### STANDARDS

BSP threaded according to standard ISO 228-1.

